

SITE PLAN OF A PROJECT OF LAND OF R.S.&L.R.DAG NO-3085 R.S. L.R. KHATIAN NO -9200, 9201, 9203, 9361, 9362 & 4024, AT MOUZA-GHUNI J.L. NO-23.IN P.S NEW TOWN. DISTRICT- NORTH 24 PARGANAS.WITHIN THE LOCAL LIMIT OF JYANGRA HATIARA NO-2 GRAM PANCHAYET.

NAME OF OWNER : PANASIA CONCLAVE PVT. LTD.



TOTAL AREA OF LAND (IN DEED) =934.33 SQM  
TOTAL AREA OF LAND (IN PHYSICAL) =934.33 SQM

Latitude 22°35'23.84" N  
Longitude 88°27'8.16" E

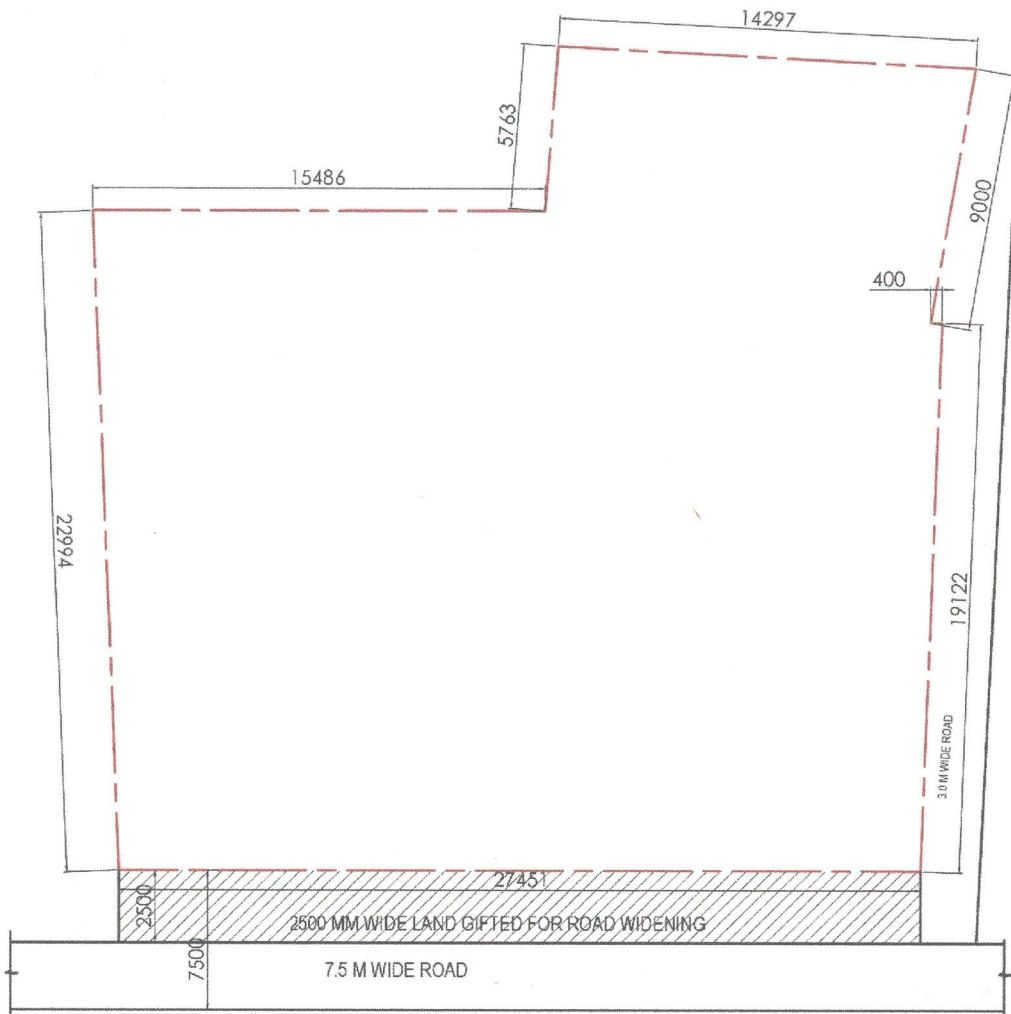

*Sanjay Mandal*

Signature of Architect  
Sanjay Mandal  
C.O.A. REG. NO. CA/98/23621

**SANJAY MANDAL**  
**CA/98/23621**

26/2 , Ballygunge Circular Road, Udayan Park, 3rd Floor, Kolkata- 700 019

T- [+91] 33 4000 64 22 / 23 / 24 / 25 / 26

E- innatekolkata04@gmail.com, innate\_kolkata@yahoo.co.in